

SUSTAINABLE JERSEY CITY



EMBANKMENT PRESERVATION COALITION

All-volunteer 501c3 non-profit organization
founded in 1999

MISSION

Preserve the historic Embankment
Provide passive open space
Integrate rail lines into regional network of
pedestrian and bike trails

embankment.org

RECOGNITIONS

1999	Embankment (Marin to Brunswick) - State Register of Historic Places
2000	Embankment - National Register of Historic Places (determined eligible)
2003	Embankment - Jersey City Municipal Landmark
2004	Harsimus Branch - Recommended segment of East Coast Greenway, NJDOT study
2005	Embankment - Preservation New Jersey's "10 Most Endangered Historic Sites" list.
2005	Embankment - Priority Acquisition, Hudson County Open Space & Recreation Plan
2005	Embankment - Highest Priority Acquisition Site, NY/NJ Harbor Estuary Habitat Program
2006	Embankment - Jersey City Municipal Landmark (re-designated)
2009	Embankment - Needed ROW for multiple uses, Jersey City Master Plan
2011	Embankment - National Trust for Historic Preservation national challenge, 7th place
2018	Entire Harsimus Branch (Marin to Waldo) and associated sites - SHPO Opinions

COLLABORATORS AND SUPPORTERS

Local Businesses
Neighborhood Associations
Citywide Organizations
Regional and National Nonprofits

<https://www.embankment.org/endorsements>

An aerial photograph of New York City, specifically the area around the Hudson River and the George Washington Bridge. The image is overlaid with a semi-transparent map showing proposed project areas. These areas are highlighted in green and purple. The labels are placed over these highlighted areas. The background is a grayscale aerial view of the city's street grid and buildings.

RESERVOIR NO 3

BERGEN ARCHES

EMBANKMENT

CROSSROADS

JOURNAL SQUARE

**LIBERTY
STATE PARK**

JERSEY CITY EAST COAST GREENWAY

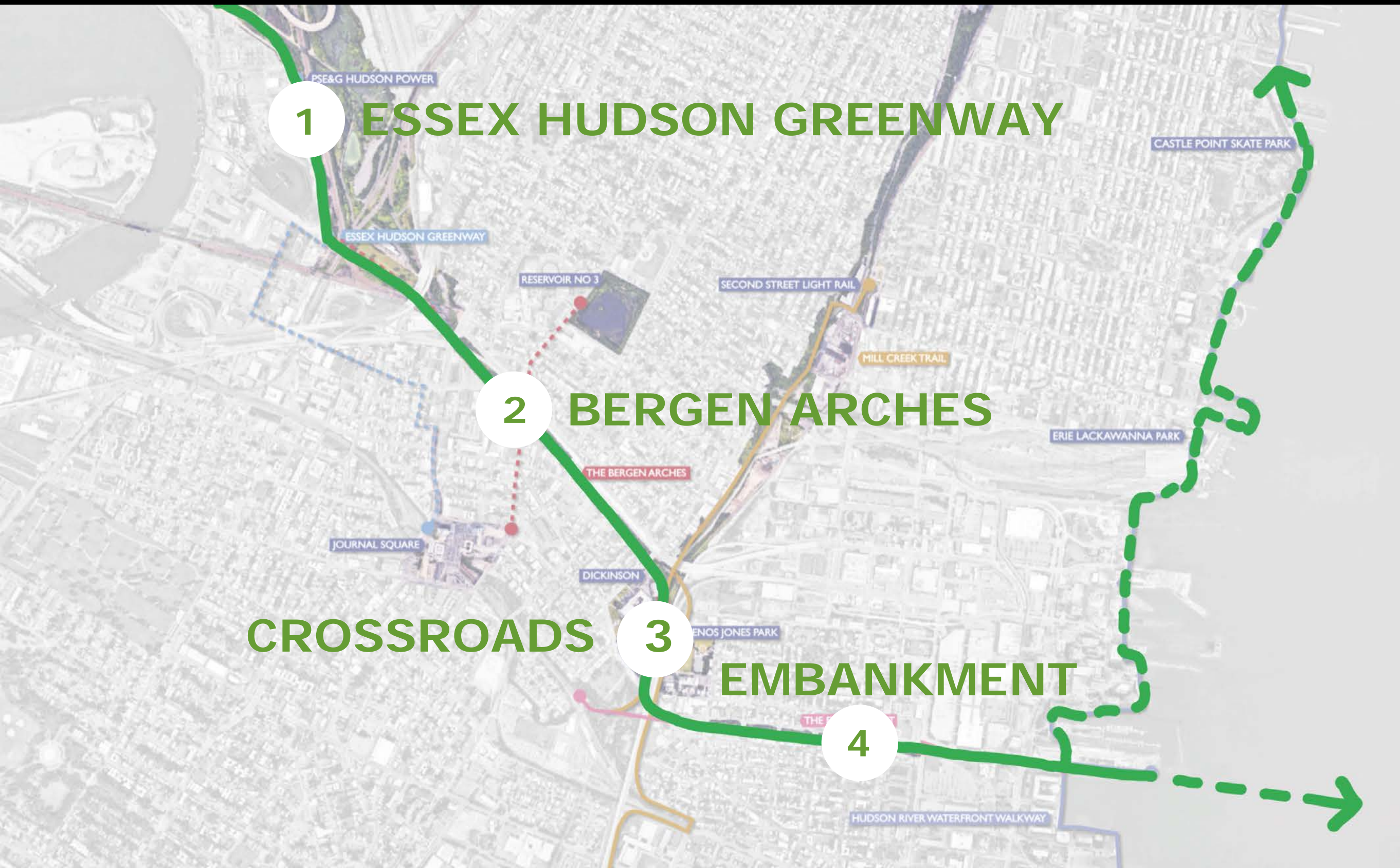

CROSSROADS INITIATIVE







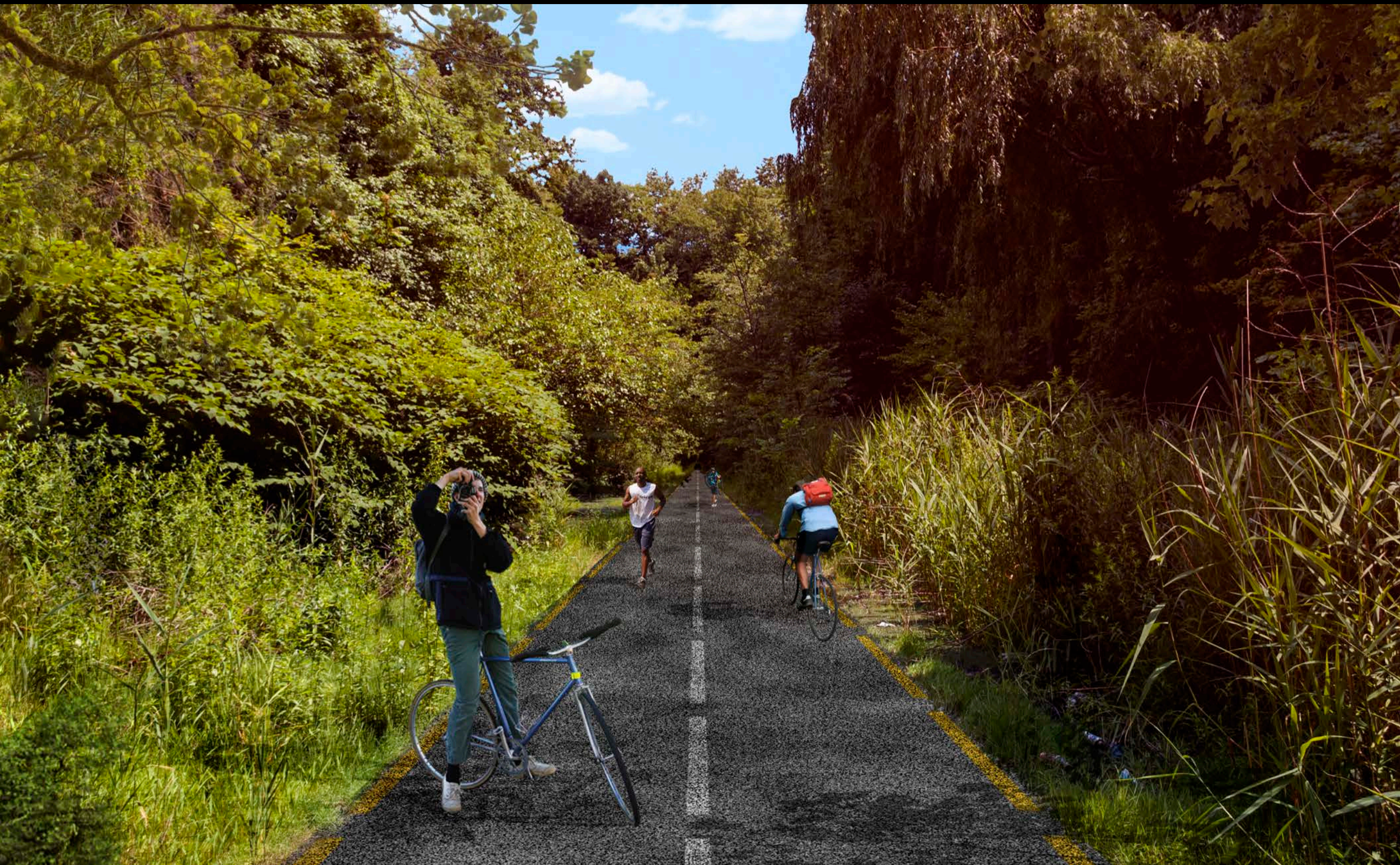







the embankment

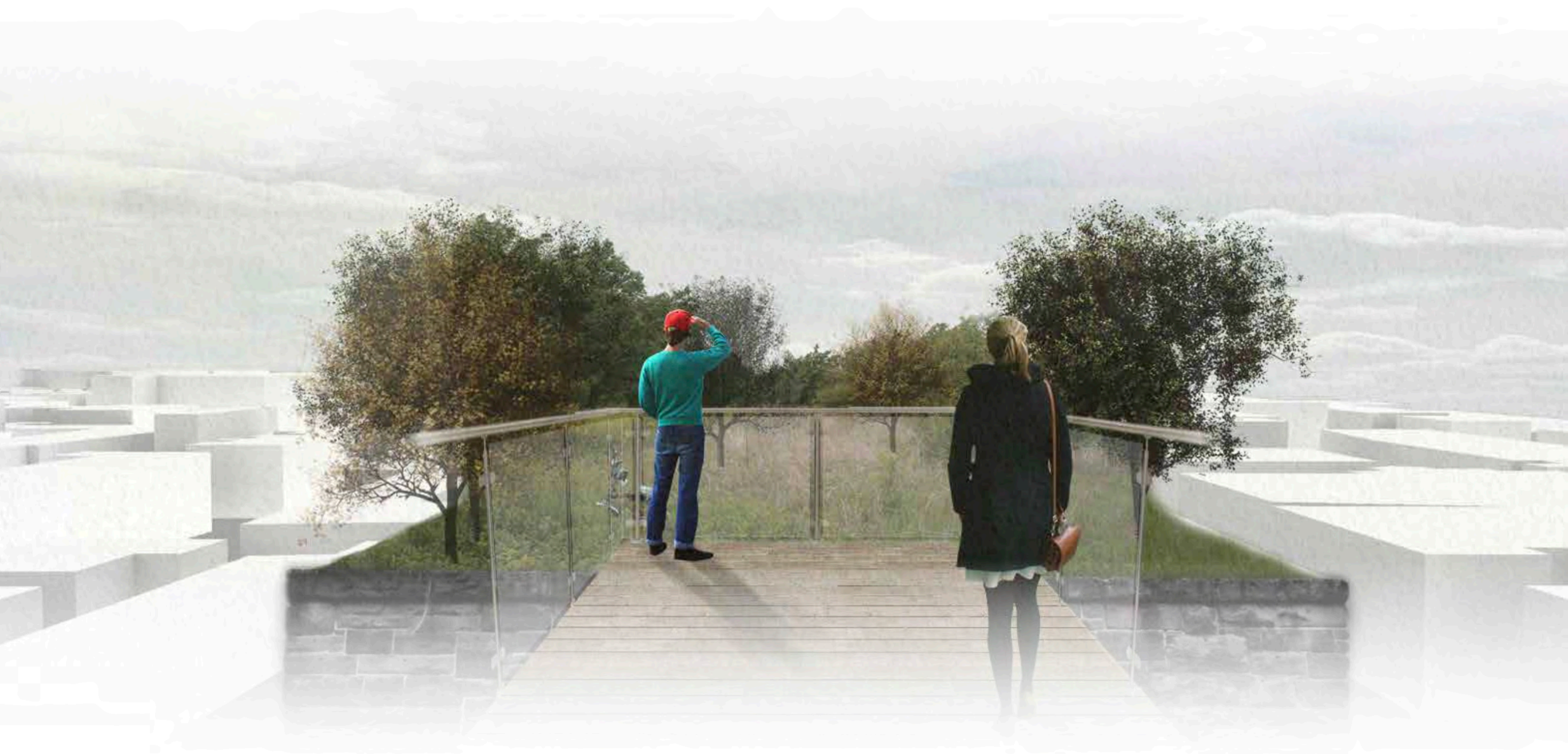

COALITION'S SUSTAINABILITY ADVOCACY

Studies

- Historic preservation
- Habitat – present and recommended
- Soil remediation mapping to guide design

Treatment Considerations

- Forest & meadow preservation
- Active areas sensitive to passive emphasis
- Trail permeable surfaces
- Habitat Stepping Stones
- Stormwater Containment
- Low Maintenance

WHAT A THOUGHTFUL PUBLIC CAN DO

- Restore degraded land
- Support living organisms that have found a niche in urban hardscape
- Introduce native species extinguished by industrial uses
- Sequester carbon
- Control stormwater
- Provide environmentally sensitive transportation and recreation
- Reconnect our children with nature